

Species, Yr Est, Acres

- lob 1992, 16.4
- cypress 2003, 23.7
- non-forest 0.8
- lob 1997, 7.7 ★
- lob 1998, 7.4
- lob 2000, 10
- lob 2004, 4.7
- lob 2006, 17
- lob 2006, 3.7
- lob and cypress 1990, 54.6
- longleaf 1997, 27.1 ★
- longleaf 1999, 8.4
- longleaf 2002, 2.2
- longleaf 2002, 6.8
- mixed 2004, 5.9
- pond, 0.1
- pond, 1

★ Stands currently raked, 34.8 acres

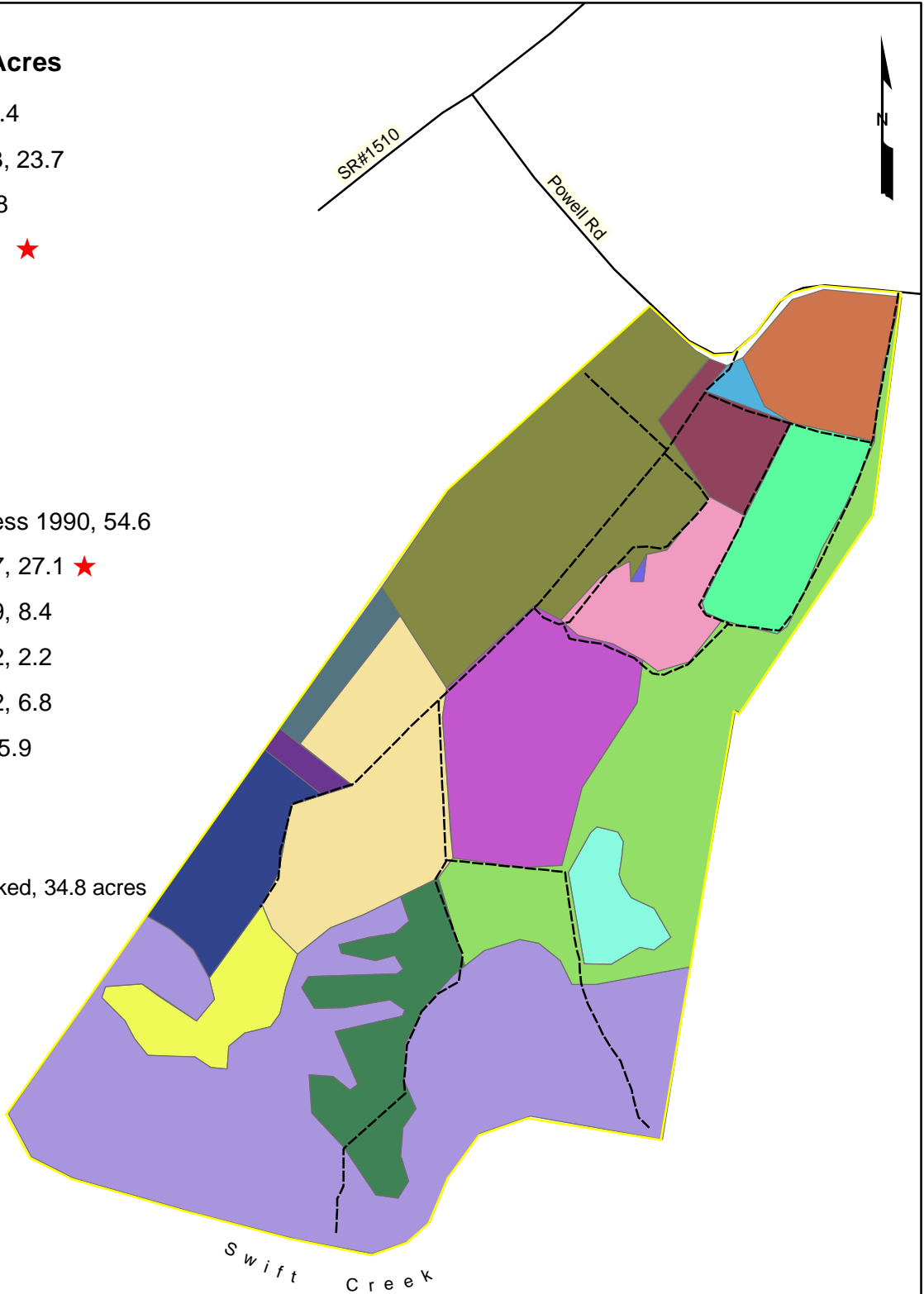

Name: Powell
 Total Acres: 198±
 County: Craven
 Date: 8/20/07

Dirt Road:
 Path:
 Stream:
 Scale: 1 inch equals 713 feet

CAROLINA FORESTRY
 Consulting Forestry and Real Estate

3101 Edwards Mill Rd, Ste. 117 Raleigh, NC 27612

Office: 919-510-4663 Web: www.carolinaforestry.com

Disclaimer: Boundary lines drawn from county tax maps and should be considered approximate. This is not a survey.