

S.D. Puckett & Associates

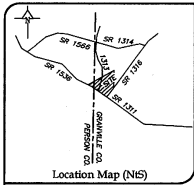

- Notes
- Area by Coordinate Method
 - No Published Horizontal Control Monument found within 2000'
 - All buildings, surface, and subsurface improvements are not necessarily depicted hereon
 - All distances are horizontal ground distances in U.S. survey feet
 - This survey performed without benefit of title examination and is made subject to any document of record which may affect subject property
 - Right of Way width of SR 1313 based on maintenance width of 30'
 - County Line location per Granville County & Person County DE
 - Located within a designated public watershed (WS-1V-DW)
 - Pin 050502004816 RECD 4385
 - Zoned AR-40
 - Setbacks: Front=50', Side=15', Rear/Corner=25'
 - 78.77 AC.s remaining

Doc ID: 00017880001 Type: CHS
 Recorded: 07/13/2007 at 05:07:58 PM
 Fee Amt: \$15.00 Page: 1 of 1
 State: NC County: Person Reg. of Deeds
 P=35 R=137

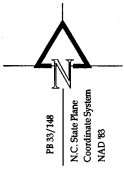

I hereby certify that I am the owner of the property shown and described herein which was conveyed to me by deed recorded in the Granville County Register of Deeds office in Book (see source doc), and that we hereby certify that this plan of subdivision was my free consent. Further, we hereby certify that the land as shown herein is within the subdivision jurisdiction of Granville County, North Carolina.

Owner: DAVID B. NEWTON, BONNIE N. NELSON & CHARLES W. NEWTON Date: 7/17/07

I, hereby certify that the subdivision plot as depicted hereon has been granted final approval pursuant to the Granville County Subdivision Regulations.

Professional Land Surveyor: STEPHEN M. PUCKETT Date: 7-19-07

State of North Carolina
 County of Granville

STEPHEN M. PUCKETT Register of Deeds
 I, STEPHEN M. PUCKETT, Register of Deeds of Granville County, certify that the map or plan which this subdivision was prepared in accordance with the requirements of the Granville County Subdivision Regulations was duly filed for recording on 7-19-07 and duly recorded.

State of North Carolina

I, Stephen M. Puckett, certify that this plot was drawn under my supervision, based on information recorded in (see source document), that the boundaries not surveyed are directly indicated as being in Book (see source doc), that the ratio of precision as calculated in 1/11/2007 that this plot was prepared in accordance with G.S. 47-30 as amended, witness my original signature, registration number, and seal this 17th day of July, A.D., 2007.

Stephen M. Puckett
 Professional Land Surveyor L-3991

I, Stephen M. Puckett, certify to one or more of the following:

- That this Survey creates a subdivision of land within the area of a county or municipality that has an ordinance that regulates parcels of land.
- That this Survey is located in a portion of a County or Municipality that is unincorporated as to an ordinance that regulates parcels of land.
- One of the following:
 - That this is of an existing parcel or parcels of land and does not create a new street or change an existing street.
 - That this Survey is of an existing building or other structure, or natural features, such as a watercourse.
 - That this Survey is a Control Survey.
- That this plot is of a Survey of another category such as a recombination of existing parcels, a court-ordered survey or other exception to the definition of subdivision.
- That this information enables me to file a survey to such that I am unable to make a determination to the best of my professional ability as to the provisions in A-C above.

Stephen M. Puckett
 Stephen M. Puckett L-3991



S.D. Puckett & Associates
 Professional Land Surveyors
 1555 Lake Road
 Creedmoor, NC 27522
 P: 919-528-8900 F: 919-528-8990
 Stephen M. Puckett L-3991

- Legend
- Existing Iron Pipe/Rod
 - New Iron Pipe
 - Existing Nail
 - Nail Set
 - Computed Point
 - Concrete Monument
 - Control Monument
 - Right of Way
 - Centerline
 - Property Line

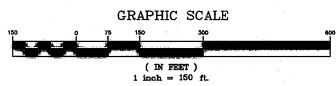

Source Documents
 DB 1148/639
 PB 33/148
 PC 14/337 (Person Co.)

Minor Subdivision for:
Lucky 38 Farms, LLC
 July 17, 2007
 Township of Walnut Grove - County of Granville - State of N.C.
 Township of Allensville - County of Person

LINE	BEARING	LENGTH
L1	N48°51'07"W	48.01'
L2	N50°03'39"W	74.20'
L3	N81°17'01"W	75.20'
L4	N52°04'49"W	112.20'
L5	N45°03'22"W	78.41'
L6	N65°31'18"W	21.11'
L7	N57°14'47"W	28.19'
L8	N68°30'22"W	24.98'
L9	N58°00'00"W	209.89'
L10	N71°02'29"W	243.48'
L11	N12°14'51"E	105.03'
L12	N17°46'38"E	165.25'
L13	N11°09'42"E	109.03'
L14	N11°09'42"E	158.05'