

PRELIMINARY SOIL/SITE SUITABILITY SKETCH MAP

HESTER TRACT - GRANVILLE COUNTY, NC

17 Acre LOT

BILL TURNER & JOHN M. MAGAS



SVEC, P.A.

Job # 8456.52

OCTOBER, 2006

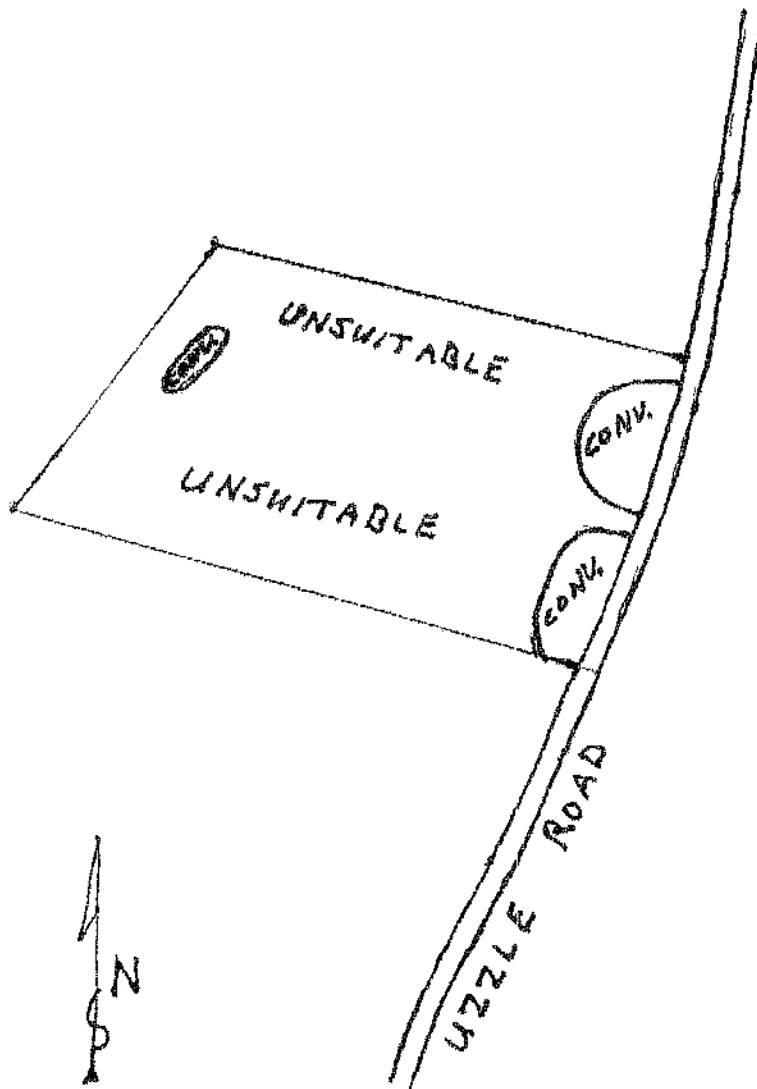

Legend:  
CONV. - 24 TO 30 INCH SOILS  
WITH POTENTIAL FOR  
CONVENTIONAL SEPTIC SYSTEMS  
(AREAS FLAGGED WITH DRAINAGE LOAD)  
UNSUITABLE - UNSUITABLE  
SOILS

(NO SCALE)

ESTIMATED AREAS